



GABRIEL DUMONT INSTITUTE  
OF NATIVE STUDIES AND APPLIED RESEARCH

**BACKGROUND RESEARCH**

**ON**

**LA LOCHE AND CUMBERLAND HOUSE**

**Research and Development**

**May 1989**

TEN YEAR POPULATION GROWTH, 1978 to 1988

|                          | <u>Saskatchewan<br/>Population</u> | <u>La Loche<br/>Population</u> | <u>Cumberland House<br/>Population</u> |
|--------------------------|------------------------------------|--------------------------------|--|
| 1978                     | 970,510                            | 1,658                          | 847                                    |
| 1979                     | 976,734                            | 1,659                          | 930                                    |
| 1980                     | 982,257                            | 1,700                          | 871                                    |
| 1981                     | 990,746                            | 1,729                          | 916                                    |
| 1982                     | 1,000,667                          | 1,784                          | 924                                    |
| 1983                     | 1,014,496                          | 1,752                          | 962                                    |
| 1984                     | 1,028,965                          | 1,813                          | 954                                    |
| 1985                     | 1,039,249                          | 1,832                          | 1,017                                  |
| 1986                     | 1,041,358                          | 1,847                          | 995                                    |
| 1987                     | 1,045,440                          | 1,872                          | 915                                    |
| 1988                     | 1,044,151                          | 1,910                          | 869                                    |
| <hr/>                    |                                    |                                |  |
| % Increase<br>1978 to 88 | +7.6                               | +15.2                          | +2.6                                   |

Source: Saskatchewan Health Insurance Registration,  
Covered Population, 1978 to 1988.

Highlights

- In the ten year period, 1978 to 1988, the population of Saskatchewan increased by 7.6 percent. In Cumberland House the population increased from 847 in 1978 to a high of 1,017 in 1975 (a 20 percent increase). Since that time, however, the **Cumberland House** population has steadily declined and in 1988 was only 869, a mere 2.6 percent higher than its 1978 population.
- Unlike Cumberland House, the La Loche population continues to expand, and from 1978 to 1988 shows an overall increase of just over 15 percent.

POPULATION AGE PROFILE, 1986

| <u>Age Category</u> | <u>Total<br/>Saskatchewan</u><br>(n = 1,009,605) | <u>Northern<br/>Saskatchewan</u><br>(n = 25,335) | <u>La Loche</u><br>(n = 1,635) | <u>Cumberland House</u><br>(n = 885) |
|---------------------|--|--|--------------------------------|--------------------------------------|
| 0 - 14 years        | 24.3%  | 38.7%  | 40.7%                          | 39.8%                                |
| 15 - 24 years       | 16.6%  | 20.9%  | 25.7%                          | 22.2%                                |
| 25 - 44 years       | 28.6%  | 25.3%  | 22.3%                          | 24.6%                                |
| 45 - 64 years       | 17.7%  | 10.0%  | 8.6%                           | 8.8%                                 |
| 65+ years           | <u>12.7%</u>                                     | <u>4.2%</u>                                      | <u>2.8%</u>                    | <u>4.7%</u>                          |
| Total               | 100 %  | 100 %  | 100 %                          | 100 %                                |

Source: Statistics Canada, Profiles Sask  
Part I, Catalogue 94-115, 1987.

Highlights

- The population age structure in Northern Saskatchewan has significant deviation from the age structure of the province as a whole.
- Both La Loche and Cumberland House have a very young population base with approximately 40 percent in the 0 to 14 year age cohort. The comparative provincial proportion, of 0 to 14 year olds, is 24.3 percent.
- La Loche and Cumberland House have extremely low numbers of elderly residents. In fact, the percentage of people age 45 and over in La Loche (11.4%) and Cumberland House (13.5%) closely approximate the provincial percentage for the 65 and over population (12.7%).

**HIGHEST LEVEL OF SCHOOLING FOR POPULATION**  
**15 YEARS AND OVER, 1986**

|                                       | <u>Total<br/>Saskatchewan</u> | <u>Northern<br/>Saskatchewan</u> | <u>La Loche</u> | <u>Cumberland<br/>House</u> |
|---------------------------------------|-------------------------------|----------------------------------|-----------------|-----------------------------|
| Total Population 15 <sup>+</sup>      | 751,090                       | 15,500                           | 945             | 515                         |
| Less than grade 9                     | 19.2%                         | 42.8%                            | 65.1%           | 40.2%                       |
| Grade 9-13 (no diploma)               | 32.9%                         | 25.6%                            | 14.8%           | 27.2%                       |
| High School Diploma<br>or Certificate | 8.6%                          | 3.8%                             | 15.9%           | 2.9%                        |
| Trades Certificate                    | 9.1%                          | 1.6%                             | 2.1%            | 1.9%                        |
| Other non-university education        |                               |                                  |                 |                             |
| - without certificate                 | 11.8%                         | 5.8%                             | 6.8%            | 11.7%                       |
| - with certificate                    | 11.0%                         | 10.0%                            | 7.9%            | 10.7%                       |
| University                            |                               |                                  |                 |                             |
| - without degree                      | 11.0%                         | 5.5%                             | 6.8%            | 2.9%                        |
| - with degree                         | 7.4%                          | 4.8%                             | 2.1%            | 1.9%                        |

Source: Statistics Canada, Profile Sask Part II,  
Catalogue 94-116, Sept. 1987.

**Highlights**

- Educational achievement in Northern Saskatchewan lags far behind that of the general provincial population. Only 19 percent of Saskatchewan adults, age 15 years and older, have less than a grade 9 education, the commonly used benchmark for functional literacy. Many of those with low levels of education are elderly.
- In contrast, 40 percent of Cumberland House adults, age 15 and over, have less than a grade nine education. In La Loche this statistic rises to 65 percent. As very few elderly people live in these two communities, the poorly educated population is largely between the ages of 15 and 45 years.
- In sum, while one out of every two Saskatchewan residents does not have a high school diploma/certificate or other comparable level of training, in Cumberland House this figure rises to 7 out of ten and in La Loche, 8 out of ten.

**SADAC  
Community  
Profile**

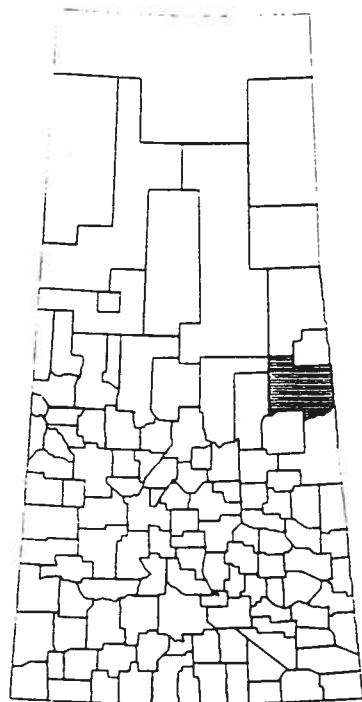

**Alcohol and Drug Related  
Legal Offences (1986)  
for the Community and Surrounding Area of  
Cumberland House**

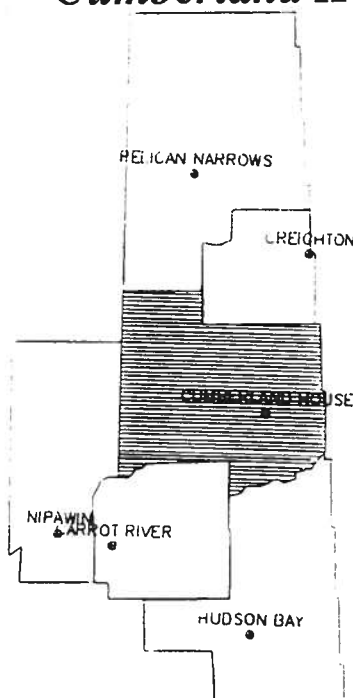

| Type of Offence              | <b>Cumberland House</b> |   | <b>Saskatchewan</b> |   |
|------------------------------|-------------------------|---|---------------------|---|
|                              | Offences                | Offence Rate<br>per 1,000 persons 15 yrs+ | Offences            | Offence Rate<br>per 1,000 persons 15 yrs+ |
| <b>Liquor Act</b>            |                         |   |                     |   |
| Public Drunkenness           | 59                      | 77.9                                      | 14,338              | 18.4                                      |
| Other Liquor Act             | 14                      | 18.5                                      | 26,423              | 33.8                                      |
| Liquor Act Total             | 73                      | 96.4                                      | 40,761              | 52.2                                      |
| <b>Drinking and Driving</b>  |                         |   |                     |   |
| Driving While Impaired       | 18                      | 23.8                                      | 9,423               | 12.1                                      |
| Dangerous Driving            | -                       | -   | 401                 | 0.5                                       |
| Drinking and Driving Total   | 18                      | 23.8                                      | 9,824               | 12.6                                      |
| <b>Drug</b>                  |                         |   |                     |   |
| Cannabis                     | -                       | -   | 2,040               | 2.6                                       |
| Other Drugs                  | 1                       | 1.3                                       | 412                 | 0.5                                       |
| Drug Total                   | 1                       | 1.3                                       | 2,452               | 3.1                                       |
| <b>Assault</b>               |                         |   |                     |   |
| Common Assault               | 42                      | 55.2                                      | 3,366               | 4.3                                       |
| Other Assault                | 15                      | 19.9                                      | 2,412               | 3.1                                       |
| Assault Total                | 57                      | 75.1                                      | 5,778               | 7.4                                       |
| <b>Disturbing the Peace</b>  | 13                      | 17.6                                      | 2,976               | 3.8                                       |
| <b>Total Offences</b>        | 162                     | 214.2                                     | 61,791              | 79.1                                      |
| Population 15 Years and Over | 800                     |   | 781,100             |   |

**Community Risk Indicator**

**High**

Caution: Offence rates may be due to enforcement practices as well as activities of the general population.

Note: Minor discrepancies in rate totals are due to rounding; see body of report for sources and methods.

**SADAC  
Community  
Profile**

**Alcohol and Drug Related  
Legal Offences (1986)  
for the Community and Surrounding Area of**

**La Loche**

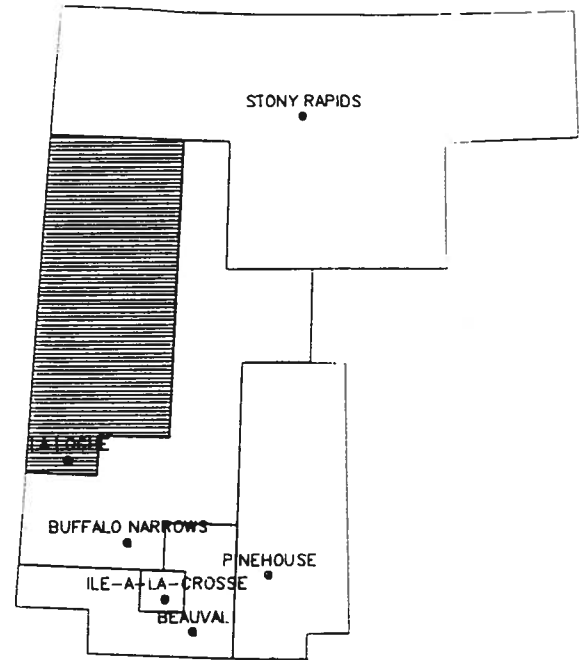
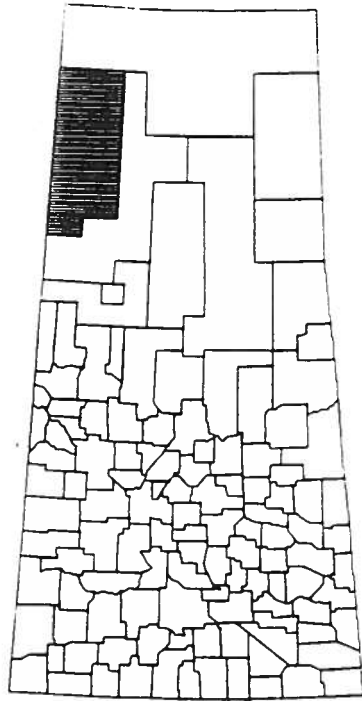

| Type of Offence              | <b>La Loche</b> |   | <b>Saskatchewan</b> |   |
|------------------------------|-----------------|---|---------------------|---|
|                              | Offences        | Offence Rate<br>per 1,000 persons 15 yrs+ | Offences            | Offence Rate<br>per 1,000 persons 15 yrs+ |
| <b>Liquor Act</b>            |                 |   |                     |   |
| Public Drunkenness           | 886             | 692.2                                     | 14,338              | 18.4                                      |
| Other Liquor Act             | 249             | 194.5                                     | 26,423              | 33.8                                      |
| Liquor Act Total             | 1,135           | 886.7                                     | 40,761              | 52.2                                      |
| <b>Drinking and Driving</b>  |                 |   |                     |   |
| Driving While Impaired       | 77              | 60.2                                      | 9,423               | 12.1                                      |
| Dangerous Driving            | 3               | 2.2                                       | 401                 | 0.5                                       |
| Drinking and Driving Total   | 80              | 62.3                                      | 9,824               | 12.6                                      |
| <b>Drug</b>                  |                 |   |                     |   |
| Cannabis                     | 5               | 3.9                                       | 2,040               | 2.6                                       |
| Other Drugs                  | -               | -   | 412                 | 0.5                                       |
| Drug Total                   | 5               | 3.9                                       | 2,452               | 3.1                                       |
| <b>Assault</b>               |                 |   |                     |   |
| Common Assault               | 90              | 70.1                                      | 3,366               | 4.3                                       |
| Other Assault                | 75              | 58.8                                      | 2,412               | 3.1                                       |
| Assault Total                | 165             | 128.8                                     | 5,778               | 7.4                                       |
| <b>Disturbing the Peace</b>  | 98              | 76.4                                      | 2,976               | 3.8                                       |
| <b>Total Offences</b>        | 1,483           | 1,158.3                                   | 61,791              | 79.1                                      |
| Population 15 Years and Over | 1,300           |   | 781,100             |   |

**Community Risk Indicator**

**High**

Caution: Offence rates may be due to enforcement practices as well as activities of the general population.  
Note: Minor discrepancies in rate totals are due to rounding; see body of report for sources and methods.

TOTAL POPULATION 5 YEARS AND OVER  
BY MOBILITY STATUS, 1981 to 1986

|                              | <u>Non-movers</u> | <u>Moved Within<br/>Census<br/>Division</u> | <u>Changed<br/>Census<br/>Divisions</u> |
|------------------------------|-------------------|---|---|
| Total Saskatchewan (1986)    | 58.0%             | 22.7%                                       | 19.3%                                   |
| Northern Saskatchewan (1986) | 57.2%             | 27.4%                                       | 15.4%                                   |
| La Loche (1986)              | 67.4%             | 26.7%                                       | 5.9%                                    |
| Cumberland House (1986)      | 68.7%             | 19.7%                                       | 11.6%                                   |

Source: Statistics Canada, Profiles Sask Part II,  
Sept. 1987, Catalogue #94-116.

Highlights

- La Loche and Cumberland House have a less mobile population than other communities in Saskatchewan. While 58 percent of Saskatchewan residents did not move between the 1981 and 1986 census, this rose to approximately 68 percent in La Loche and Cumberland House.

PERCENTAGE UNEMPLOYED POPULATION (AGE 15<sup>+</sup>)  
BY AGE AND SEX, 1986

|                       | <u>Males</u> | <u>Females</u> | <u>Age</u><br>15 - 24 | <u>Age</u><br>25 <sup>+</sup> |
|-----------------------|--------------|----------------|-----------------------|-------------------------------|
| Total Saskatchewan    | 7.3%         | 9.0%           | 17.0%                 | 8.5%                          |
| Northern Saskatchewan | 25.5%        | 20.8%          | 39.4%                 | 18.1%                         |
| La Loche              | 50.9%        | 28.6%          | 62.1%                 | 34.6%                         |
| Cumberland House      | 57.1%        | 50.0%          | 70.0%                 | 47.4%                         |

Source: Statistics Canada, Profiles Sask Part II,  
Catalogue 94-116, 1987.

Highlights

- While unemployment rates in Northern Saskatchewan are two to three times higher than the provincial average, the communities of La Loche and Cumberland House fare poorly even in a northern context. In these communities, 60 to 70 percent of young adults, age 15 to 24, were unemployed in 1986, and even older adults had unemployment rates as high as 35 percent in La Loche and 47 percent in Cumberland House.

AVERAGE NUMBER OF CHILDREN PER CENSUS FAMILY, 1986

|                       |     |
|-----------------------|-----|
| Total Saskatchewan    | 1.3 |
| Northern Saskatchewan | 2.4 |
| La Loche              | 3.6 |
| Cumberland House      | 2.8 |

Source: Statistics Canada, Profiles Sask  
Part I, Catalogue #94-115, 1987.

Highlights

- Very few family households in either La Loche (8.2%) or Cumberland House (6.5%) might be termed "empty nesters" or husband-wife families whose children have left home. In contrast, at least one-third of Saskatchewan families can be classified in the "empty nest" category.
- Seventeen percent of Saskatchewan families having children at home are headed by a single parent. Like other Northern Saskatchewan communities, La Loche and Cumberland House exhibit extremely high rates of lone-parent families, 30 and 38 percent respectively.
- While only a minority of Saskatchewan families (17.6%) have 3 or more children at home, Northern Saskatchewan communities show a marked variation. In Cumberland House more than half of the families with children (53.5%) have three or more living at home. In La Loche this figure rises to 63.6 percent.

**FAMILY HOUSEHOLD TYPES, 1986**

|                          | <u>Total<br/>Saskatchewan</u> | <u>Northern<br/>Saskatchewan</u> | <u>La Loche</u> | <u>Cumberland House</u> |
|--------------------------|-------------------------------|----------------------------------|-----------------|-------------------------|
| H-W, No children at home | 34.3%                         | 16.5%                            | 8.2%            | 6.5%                    |
| H-W, Children at home    | 54.5%                         | 61.9%                            | 63.3%           | 58.1%                   |
| Lone Parent              | 11.2%                         | 21.7%                            | 26.5%           | 35.5%                   |

Source: Statistics Canada, Profiles Sask  
Part I, Catalogue #94-115, 1987.

**LONE-PARENT FAMILIES AS A PERCENTAGE  
OF ALL FAMILIES HAVING CHILDREN AT HOME, 1986**

|                       |       |
|-----------------------|-------|
| Total Saskatchewan    | 17.0% |
| Northern Saskatchewan | 25.8% |
| La Loche              | 29.6% |
| Cumberland House      | 37.9% |

Source: Statistics Canada, Profiles Sask  
Part I, Catalogue #94-115, 1987.

**FAMILIES WITH CHILDREN BY NUMBER OF  
CHILDREN AT HOME, 1986**

|                       | <u>1 or 2</u> | <u>3 or more</u> |
|-----------------------|---------------|------------------|
| Total Saskatchewan    | 82.4%         | 17.6%            |
| Northern Saskatchewan | 59.6%         | 40.4%            |
| La Loche              | 36.4%         | 63.6%            |
| Cumberland House      | 46.5%         | 53.5%            |

Source: Statistics Canada, Profiles Sask  
Part I, Catalogue #94-115, 1987.

Highlights

- Only 3 percent of the Cumberland House population are provincial public servants. In La Loche the figure is slightly higher at 4 percent. These differ considerably from La Ronge where 11 percent of the population have permanent positions with the provincial public service.
- In both communities health and education are the two largest provincial departments represented.

NORTHERN SASKATCHEWAN  
PERMANENT PROVINCIAL EMPLOYEES, 1988

|                  | Agriculture | Education | ED&T | Social Services | Health | Highways | Justice | PR&C | SaskTel | SFC | Urban Affairs | Legal Aid | SADAC | SPMC | Total |
|------------------|-------------|-----------|------|-----------------|--------|----------|---------|------|---------|-----|---------------|-----------|-------|------|-------|
| Beauval          |             | 18        |      |                 | 5      | 3        |         | 3    |         | 2   |               |           |       |      | 31    |
| Buffalo Narrows  |             | 19        | 4    | 11              | 10     | 7        | 9       | 7    | 3       | 3   | 1             |           | 1     | 9    | 84    |
| Creighton        |             | 28        | 3    | 7               | 6      | 2        | 2       | 5    | 1       | 3   |               |           | 1     | 6    | 64    |
| Cumberland House | 5           | 19        |      |                 | 7      |          |         | 3    |         |     |               |           |       |      | 34    |
| Dore Lake        | f           | 1         |      |                 |        |          |         | 2    |         |     |               |           |       |      | 3     |
| Green Lake       | 12          | 13        |      |                 | 1      |          |         | 1    |         |     |               |           |       |      | 27    |
| Ile a la Crosse  | 2           | 22        |      |                 | 41     |          |         | 1    |         |     |               |           |       |      | 69    |
| La Loche         |             | 43        |      | 8               | 26     | 6        | 1       | 2    |         |     |               |           | 1     |      | 87    |
| La Ronge         | 3           | 65        | 27   | 14              | 69     | 2        | 19      | 25   | 12      | 4   | 12            | 7         | 3     | 42   | 304   |
| Pelican Narrows  |             |           |      |                 |        |          |         | 5    |         |     |               |           |       |      | 5     |
| Pine House       |             | 17        |      |                 | 5      | 2        |         | 3    |         |     |               |           |       |      | 27    |
| Sandy Bay        |             | 21        |      |                 | 5      |          |         | 1    |         |     |               |           |       | 1    | 28    |
| Weyakwin         |             | 3         |      |                 | 1      |          |         | 1    |         |     |               |           |       |      | 5     |
| Stony Rapids     |             | 4         |      |                 | 1      |          |         | 4    |         |     |               |           |       |      | 9     |
| Wollaston Lake   |             | 12        |      |                 |        | 1        |         | 1    |         |     |               |           |       |      | 14    |
| Uranium City     |             | 1         |      |                 | 23     |          |         |      | 1       |     |               |           |       |      | 25    |
| Turnor Lake      |             | 7         |      |                 |        |          |         |      |         |     |               |           |       |      | 7     |
| Total            | 22          | 293       | 34   | 40              | 200    | 23       | 31      | 64   | 17      | 12  | 13            | 7         | 6     | 58   | 820   |

Source: Northern Affairs Secretariat  
August 1988.

# Where do Public Servants Live ?

Number of Permanent Public Servants, compared to the Populations of Six Selected Communities in which they Reside.

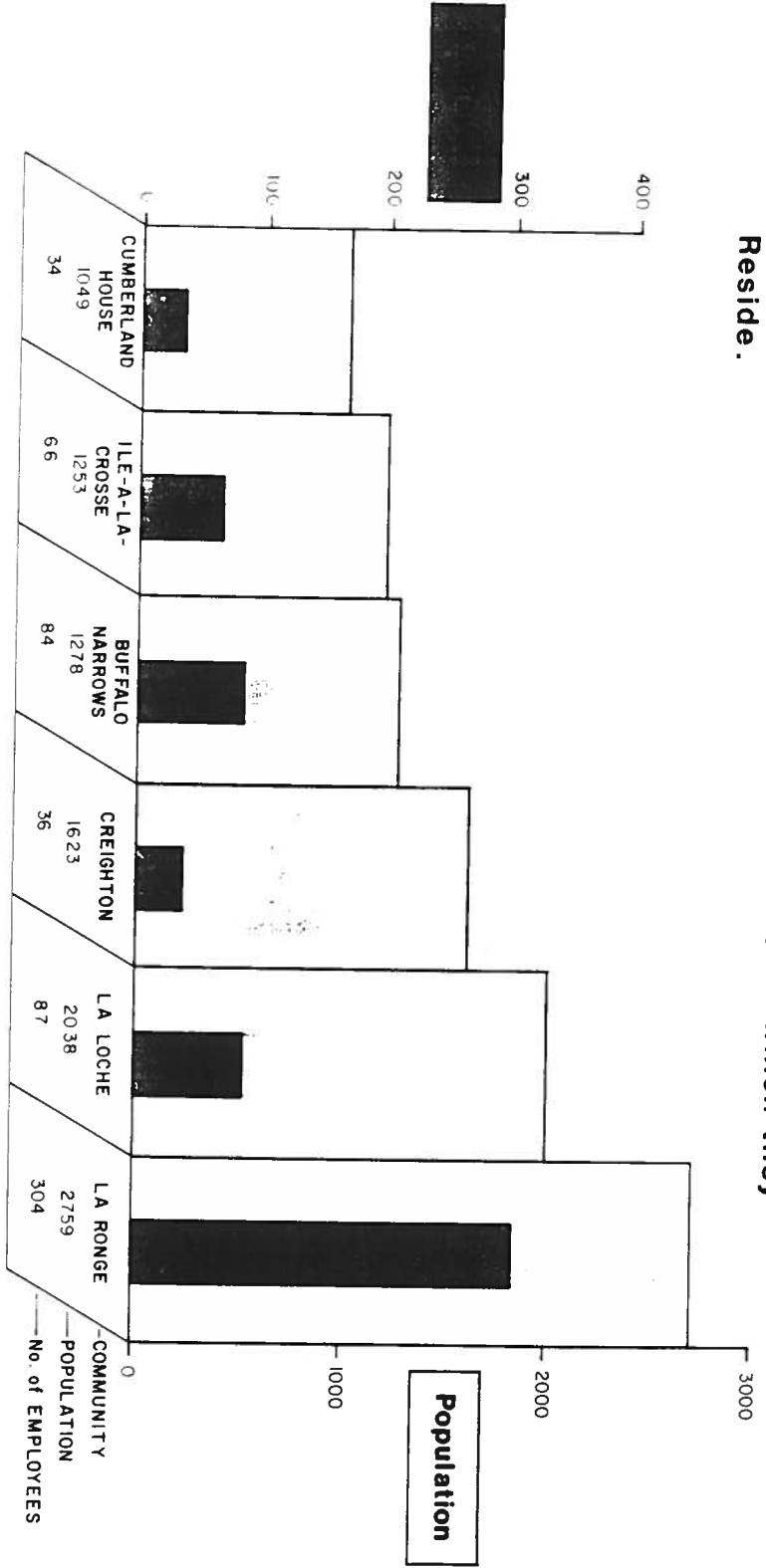

N.A.S. Aug 1988

PRIVATE HOUSEHOLDS BY SIZE, 1986

| <u>Number of<br/>Person in Household</u> | <u>Total<br/>Saskatchewan</u> | <u>Northern<br/>Saskatchewan</u> | <u>La Loche</u> | <u>Cumberland House</u> |
|--|-------------------------------|----------------------------------|-----------------|-------------------------|
| one                                      | 23.4%                         | 14.0%                            | 12.3%           | 16.7%                   |
| two                                      | 30.3%                         | 17.0%                            | 12.3%           | 11.1%                   |
| three                                    | 15.6%                         | 14.0%                            | 8.8%            | 11.1%                   |
| four to five                             | 26.0%                         | 29.1%                            | 21.1%           | 22.2%                   |
| six to nine                              | 4.4%                          | 21.1%                            | 28.1%           | 30.6%                   |
| ten or more                              | <u>0.2%</u>                   | <u>4.8%</u>                      | <u>17.5%</u>    | <u>8.3%</u>             |
|  | 100 %                         | 100 %                            | 100 %           | 100 %                   |

Source: Statistics Canada, Profiles Sask  
Part I, Catalogue #94-115, 1987.

Highlights

- Only 4.6 percent of Saskatchewan households contain six or more members. In the north this figure rises dramatically to 26 percent and even this is exceeded greatly by the communities under study. In Cumberland House 39 percent of all households have six or more people. In La Loche this rises to 46 percent.

### HOUSEHOLD INCOME CHARACTERISTICS, 1985

| <u>Place</u>          | <u>A.<br/>Average<br/>Household<br/>Income</u> | <u>B.<br/>Average<br/># Persons/<br/>Household</u> | <u>A/B<br/>Average<br/>Income<br/>Per Person*</u> |
|-----------------------|--|--|---|
| Saskatchewan          | \$30,786                                       | 2.7  | \$11,402  |
| Northern Saskatchewan | \$25,791                                       | 4.2  | \$ 6,141  |
| La Loche              | 22,947   | 5.7  | \$ 4,026  |
| Cumberland House      | \$21,061                                       | 4.8  | \$ 4,388  |

**\*Note:** Estimated using household income for the year 1985 divided by the average number of persons per household in June 1986.

Calculated from Statistics Canada, Profiles  
Sask Part II, Catalogue #94-115, 1987.

#### Highlights

- Not only do La Loche and Cumberland House have average family incomes which are eight to nine thousand dollars lower than those of other Saskatchewan households, but these incomes must support approximately twice as many household members. Whereas the average household in Saskatchewan earns approximately \$11,400 per household member, in La Loche and Cumberland House income per household member is only \$4,000.

PERCENTAGE OF INDIVIDUALS LIVING  
IN LOW INCOME FAMILIES, 1985

|                       |       |
|-----------------------|-------|
| Saskatchewan          | 19.0% |
| Northern Saskatchewan | 32.9% |
| La Loche              | 46.6% |
| Cumberland House      | 49.0% |

Source: Statistics Canada, Profiles Sask  
Part II, 1987, Catalogue #94-116.

Highlights

- The incidence of low income is the percentage of families/unattached individuals below Canada's low income cut-offs. For rural areas such as Northern Saskatchewan, low income cut-offs for family units (in 1985 dollars) were as follows:

| <u>Size of Family Unit</u> | <u>Low Income Cut-Off</u> |
|----------------------------|---------------------------|
| 1 person                   | \$ 7,568                  |
| 2 persons                  | \$ 9,891                  |
| 3 persons                  | \$13,244                  |
| 4 persons                  | \$15,310                  |
| 5 persons                  | \$17,803                  |
| 6 persons                  | \$19,436                  |
| 7 or more persons          | \$21,415                  |

COMPOSITION OF TOTAL INCOME

|                       | <u>Employment<br/>Income</u> | <u>Government<br/>Transfer<br/>Payments</u> | <u>Other<br/>Income</u> |
|-----------------------|------------------------------|---|-------------------------|
| Saskatchewan          | 75.4%                        | 12.5%                                       | 12.1%                   |
| Northern Saskatchewan | 74.6%                        | 21.9%                                       | 3.5%                    |
| La Loche              | 66.2%                        | 33.3%                                       | 0.6%                    |
| Cumberland House      | 63.6%                        | 32.9%                                       | 3.5%                    |

Highlights

- Unlike other communities in Saskatchewan, Government Transfer Payments provide a major source of income in Northern Saskatchewan. In both La Loche and Cumberland House, one-third of all income in the community comes from government transfer payments.

### DEPENDENCY RATIOS, 1978 and 1988

|                  | <u>Youth Dependency<br/>Ration (Age 0-14 years)</u> | <u>Aged Dependency<br/>Ratio (Age 65<sup>+</sup>)</u> | <u>Total Dependency<br/>Ratio</u> |
|------------------|---|---|-----------------------------------|
| Saskatchewan     |   |   |                                   |
| 1978             | 0.41  | 0.18  | 0.58                              |
| 1988             | 0.38  | 0.20  | 0.58                              |
| La Loche         |   |   |                                   |
| 1978             | 0.99  | 0.06  | 1.06                              |
| 1988             | 0.65  | 0.06  | 0.71                              |
| Cumberland House |   |   |                                   |
| 1978             | 0.84  | 0.09  | 0.93                              |
| 1988             | 0.65  | 0.08  | 0.73                              |

#### Highlights

- The overall provincial dependency ratio has remained steady at 0.58 for the last ten years. Simply put, for each resident, of the province, who is between the ages of 15 and 64 years, there are 0.58 old or young dependent persons.
- Ten years ago both La Loche and Cumberland House had significantly high dependency ratios, 1.06 and 0.93, respectively. The working-age population approximately equalled the dependent population. Few of the dependents were elderly.
- Over the past ten years dependency ratios in both communities have decreased so that there are approximately 0.7 dependent persons for every person of working age.

NUMBER OF FAMILIES IN PRIVATE HOUSEHOLDS, 1986

| <u># Families in Household</u> | <u>Total<br/>Saskatchewan</u><br>(n = 358,265) | <u>Northern<br/>Saskatchewan</u><br>(n = 5,895) | <u>Cumberland<br/>House</u><br>(n = 180) | <u>La Loche</u><br>(n = 285) |
|--------------------------------|--|---|--|------------------------------|
| Non-Family Household           | 27.8%  | 18.4%   | 22.2%                                    | 19.2%                        |
| One Census Family              | 71.7%  | 78.3%   | 69.4%                                    | 75.4%                        |
| Two or More Census Families    | <u>0.5%</u>                                    | <u>3.3%</u>                                     | <u>8.3%</u>                              | <u>5.3%</u>                  |
|                                | 100 %  | 100 %   | 100 %                                    | 100 %                        |

Source: Statistics Canada, Profiles Sask  
Part I, Catalogue #94-115, 1987.

Highlights

- Although the North contains only 1.9 percent of all Saskatchewan "family" households, it has 11 percent of the Saskatchewan family households which have two or more census families.
- Northern households are six times more likely to contain two or more census families than other households in Saskatchewan.

PLACE OF BIRTH, 1986

Born in Saskatchewan

|                                 |       |
|---------------------------------|-------|
| Total Saskatchewan Residents    | 78.3% |
| Northern Saskatchewan Residents | 78.4% |
| La Loche Residents              | 90.7% |
| Cumberland House Residents      | 82.6% |

Source: Statistics Canada,  
Profiles Sask Part II,  
Catalogue #94-116, Sept.  
1987.

Highlights

- Only 9 percent of La Loche residents were born outside of Saskatchewan as compared with 22 percent of the general provincial population.

K - 12 SCHOOL ENROLLMENT, 1987

| <u>La Loche</u>         | <u>Number</u> | <u>Grades</u> | <u>Teachers</u> | <u>Enrollment</u> |
|-------------------------|---------------|---------------|-----------------|-------------------|
| Elementary School       | 1             | K-6           | 23              | 469               |
| High School             | 1             | 7-12          | 20              | 302               |
| <u>Cumberland House</u> | <u>Number</u> | <u>Grades</u> | <u>Teachers</u> | <u>Enrollment</u> |
| Elementary School       | 1             | K-11          | 20              | 340               |
| High School             |               |               |                 |                   |

Source: Government of Saskatchewan,  
Community Profiles, 1987.

AVERAGE LIFE EXPECTANCY CHANGE, 1975 to 1986

| <u>Year</u> | <u>Total Saskatchewan</u> | <u>Northern Saskatchewan</u> |
|-------------|---------------------------|------------------------------|
| 1975        | 73.8                      | 65.3                         |
| 1976        | 74.1                      | 68.1                         |
| 1977        | 74.4                      | 64.5                         |
| 1978        | 74.5                      | 67.3                         |
| 1979        | 75.5                      | 64.7                         |
| 1980        | 75.6                      | 68.3                         |
| 1981        | 75.8                      | 73.2                         |
| 1982        | 75.4                      | 72.3                         |
| 1983        | 76.4                      | 73.1                         |
| 1984        | 76.7                      | 72.1                         |
| 1985        | 76.4                      | 70.1                         |
| 1986        | 76.5                      | 71.6                         |

9 years

DEATH RATE - (DEATHS PER 100,000 POPULATION)

|                            |                    |
|----------------------------|--------------------|
| 1986 Saskatchewan          | 580/100,000 people |
| 1986 Northern Saskatchewan | 826/100,000 people |

Source: Saskatchewan Health, Vital Statistics by Health Region, 1986.

Highlights

- Although the death rates in Northern Saskatchewan remain significantly higher than those of the general population of the province, life expectancies continue to rise. Since 1975 the average life expectancy of a Saskatchewan resident has risen 3 years (73.8 to 76.5 years). In the same time period the average life expectancy in Northern Saskatchewan rose more than 6 years (from 65.3 to 71.6).
- In a comparative sense, current life expectancy in Northern Saskatchewan (71.6 years) is similar to those of the total province in the early 1970's.